

# Directions to Claiborne Building Training Rooms

(1201 North Third Street)

From **I - 110** traveling North, take the **North Street exit**.

From **I - 110** traveling South, take the **Laurel exit**.

Go until you reach **Third (3rd) Street** and turn right.

Just past the State Capitol, there will be a small blinking caution light. Turn left into the **south parking lot** and park. If no parking places are available, please look on the map for additional public parking lots.

The Claiborne building is located across from Capitol Lake.

Enter through the south door.

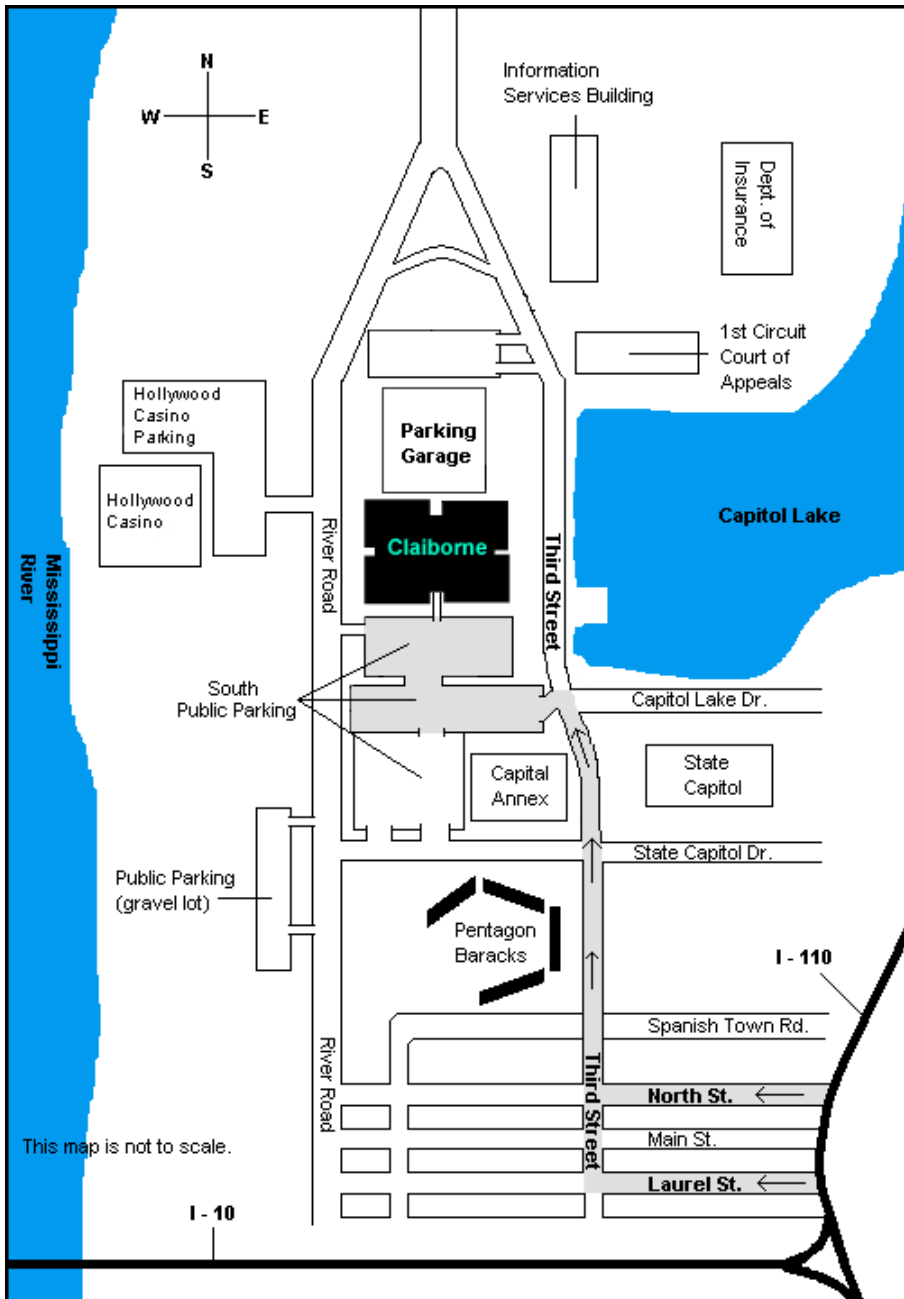

# Claiborne First Floor

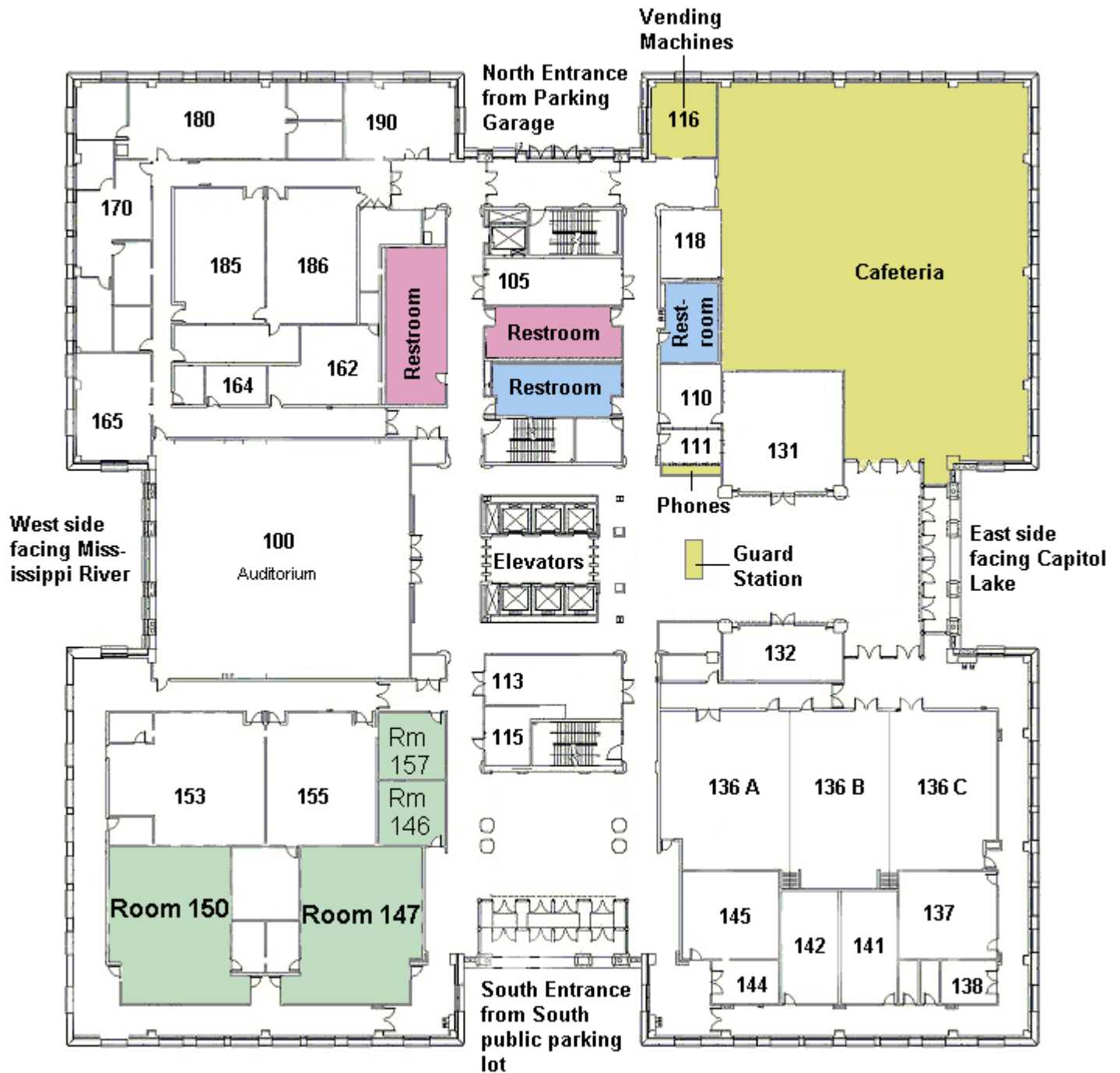

Enter through the south door (facing the visitor parking area). No sign-in is necessary for access to the first floor. To get to the large training rooms, turn left after entering the glass doors, walk to the wall, and turn left again. The training rooms are located on the first floor in the southwest corner (visitor parking lot, next to the river).